

Owner's Manual

VCL Low Power Mount (LPM) Hitch

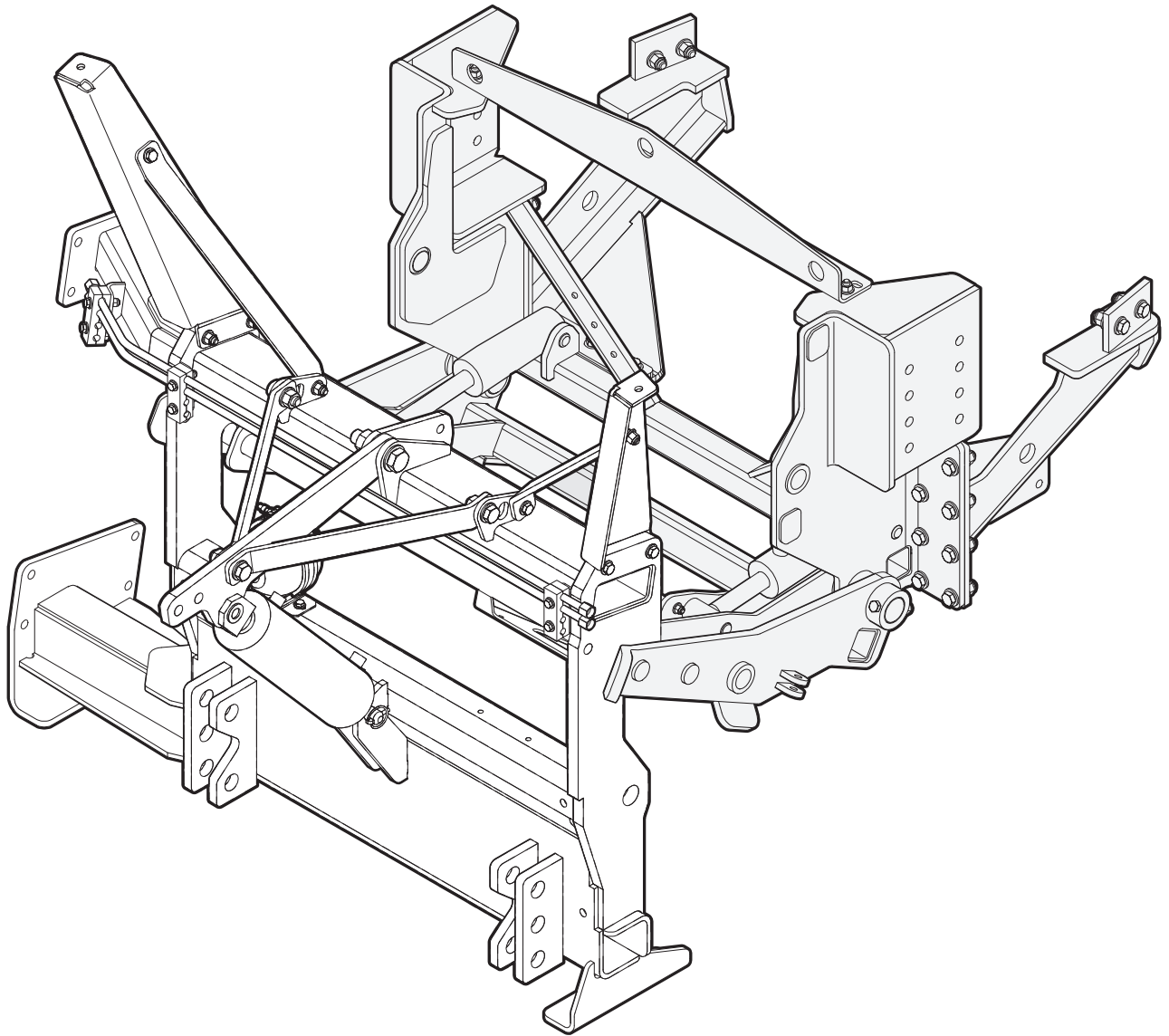

Introduction

Congratulations and thank you for your purchase of new Viking-Cives Snow & Ice Control equipment. This manual has been created to provide you with installation, set-up, operation and maintenance information for the Viking-Cives LPM Hitch. It has been prepared to familiarize you or any other person who will be assembling, operating, maintaining, or working with this product with the design features, and to instruct you in the recommended operation and maintenance of the unit.

Read this manual carefully before you operate or service your LPM Hitch. Remember that you're working with heavy equipment that can injure you or someone else. You can help lessen the chance of injury by following the procedures in this manual, carefully.



DANGER: If incorrectly used, this equipment can cause severe injury. Your chance of injury can be greatly reduced by following all safety decal notifications. All decals must be kept clean and complete. Replace any decals that are unreadable. Decals may be purchased directly from Viking-Cives Group and/or you're nearest authorized dealer. All Operator/Service people should review this manual carefully and become familiar with its contents. If anyone else besides you operates or services this equipment, make sure they read this manual and are instructed to follow all the safety procedures related to this equipment. Keep this manual available for reference whenever this product is being handled or used. Provide this manual to any new owners and/or operators.

The LPM Hitch is one of the most versatile hitches available for heavy equipment. The LPM Hitch can be described as universal accessory attachment hitch that can mount a wider range of equipment to the front end of a truck. In addition to our plows, other attachments can be mounted to provide a boom arm, mower attachment, etc... to make the front end of a plow truck more versatile throughout the seasons.

The Viking-Cives LTD LPM Hitch has been engineered and built with durability and safety of operation in mind. Viking-Cives LTD will not recommend any modifications to its products without prior written approval. Any modifications carried out without prior approval from VCL will VOID ALL WARRANTY, and will become the responsibility of the party who completed the modifications.

To ensure safe and trouble-free operation of the LPM Hitch, careful attention must be given to the critical adjustments during the initial installation and set-ups, as well as following periodic maintenance and inspection schedules.

LPM Hitch Components

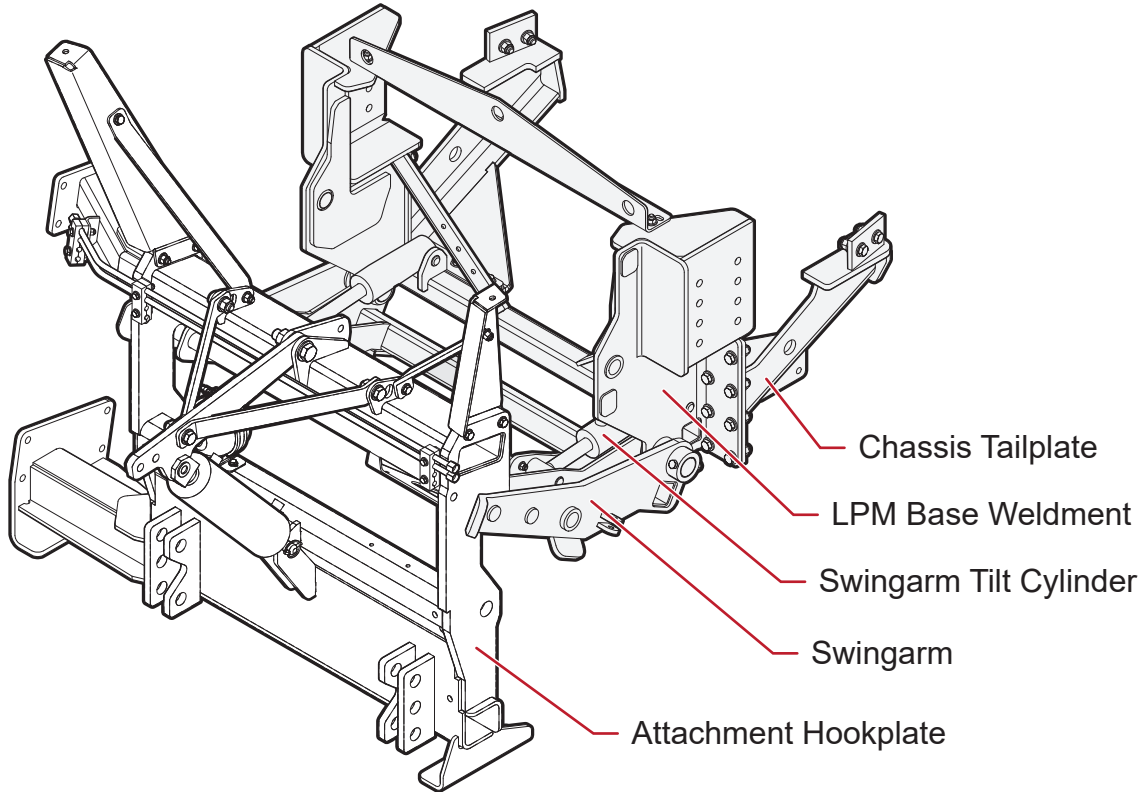

LPM Pushplate Options

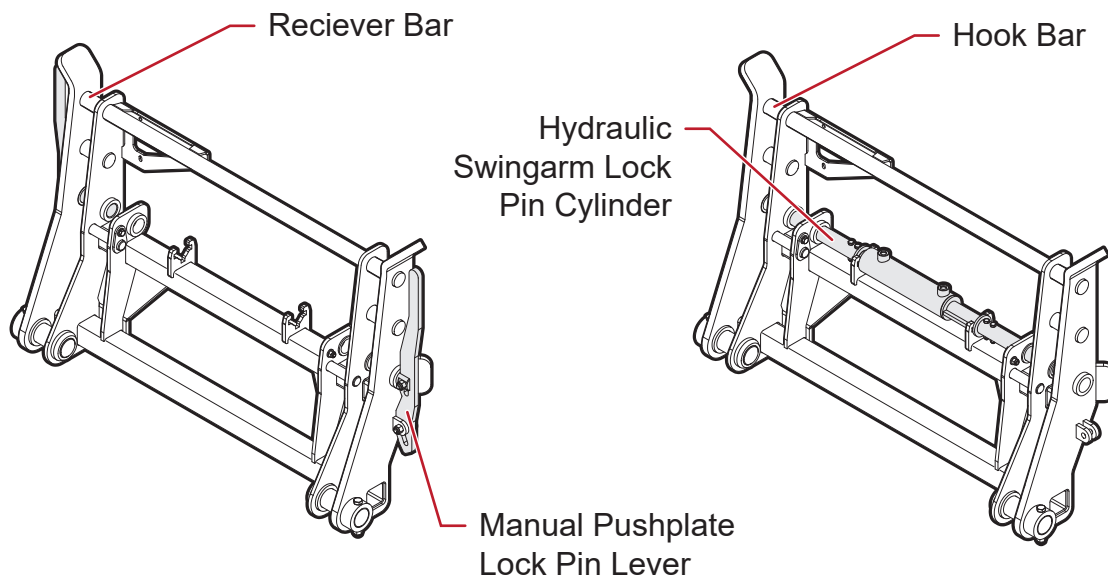

LPM Hitch Operation

The LPM Hitch features a tilting Swingarm design that can grab an Attachment Hookplate and mount it securely to the truck without the use of tools.

NOTE: The LPM Swingarm Locking Pins may be hydraulically actuated (by an in-cab lever or a bumper-mounted remote switchbox), or manually actuated (by levers located on the hitch assembly). The operator should familiarize themselves with the location and function of the locking pins prior to operating the equipment.

Attachment Procedure

NOTE: Whenever mounting an attachment to a truck using the LPM hitch, always ensure that the desired attachment is parked on a firm, level surface that is large enough to accommodate working on the truck. Uneven surfaces will make it more difficult to align the hitch and attachment and mount the attachment on the truck.

1. Release the lock pins on the Low Power Mount (LPM) Hitch, and lower the swingarm on the LPM hitch assembly.

**locking pins may be hydraulically actuated (by an in-cab lever or a bumper-mounted remote switchbox), or manually actuated (by levers located on the hitch assembly).*

2. Slowly drive the vehicle forward, and line up the hitch swingarm with the attachment hookplate.



DANGER: Never stand between the truck and the plow when the vehicle is being moved into position.

3. When the swingarm contacts the Hookplate, slowly lift the swingarm and continue to drive forward until the swingarm hooks into the hitch assembly.

**Ensure that the swingarm receiver hooks engage the hookplate in the correct location.*

4. Raise the swingarm completely, and engage the swingarm lock pins, to lock the hitch plate and plow to the vehicle.

5. Place the vehicle in park and exit the cab, to connect the hydraulic and electrical connections located on the front hitch. Visually verify, that their lock pins are engaged.

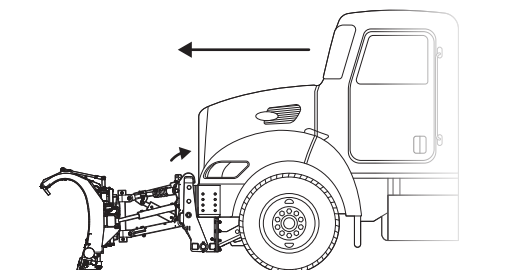
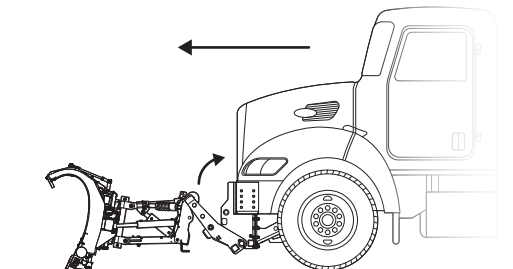
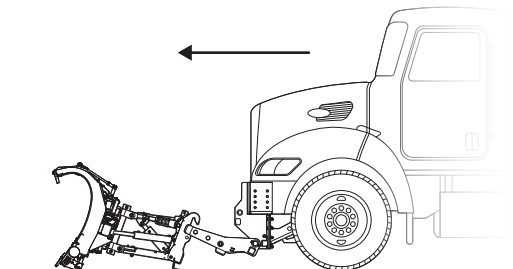
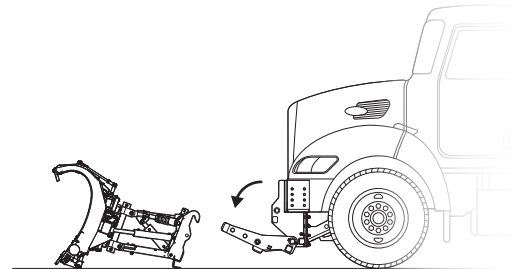

Detachment Procedure

The attachment procedure steps should be reversed to detach the attachment hookplate assembly.

NOTE: When setting down a plow find a stable & level area to place the plow, in order to make re-attachment easier.

1. Lower the plow and place the vehicle in park.
2. Exit the truck and disconnect any hydraulic hoses and electrical connections from the plow to the truck.
3. Disengage the lock pins (either located on the plow push plate, or by using the in-cab hydraulic control lever).
4. Slowly back the truck away from the plow while lowering the push plate. When the attachment hookplate is resting on the ground, continue to lower the swingarm until it is at the bottom of its range and back away entirely.
5. Raise the swingarm and engage the lock pins to secure the swingarm in the upright position.

Maintenance

The pivot points on the LPM Hitch are all fitted with greaseless bushings, and do not need lubrication.

Lubricate the hitch locking pins every 4 months to ensure smooth actuation and engagement.

Inspect the swingarm and Hookplate for excessive wear at the beginning of each season. If there is excessive wear on the main contact and lifting points of either component, contact Viking-Cives Ltd. for replacement parts.

Always keep the hydraulic and electrical connections clean and free of debris that might enter the hydraulic system, or impede electrical connections.

Inspect all hydraulic connections, fittings, and hoses for leaks at the beginning and end of each season.

